

Tous droits strictement reserves. Reproduction ou communication a des tiers interdite sous quelque forme que ce soit sans autorisation ecrite du proprietaire. Propriete de c FCI. Droits de reproduction FCI.

All rights strictly reserved. Reproduction or issue to third parties in any form whatever is not permitted without written authority from the proprietor. Property of FCI. Copyright FCI.

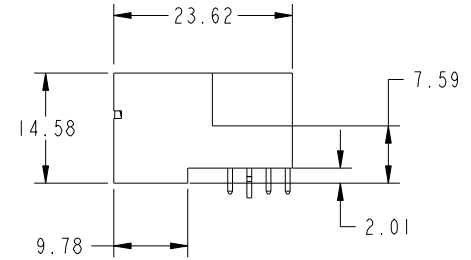
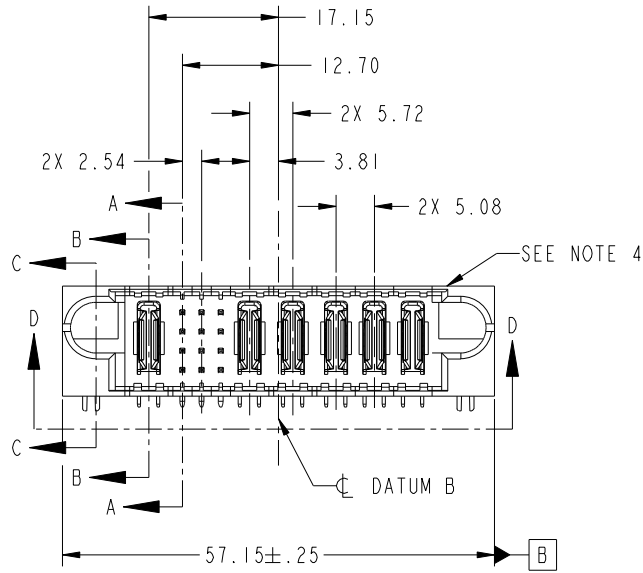
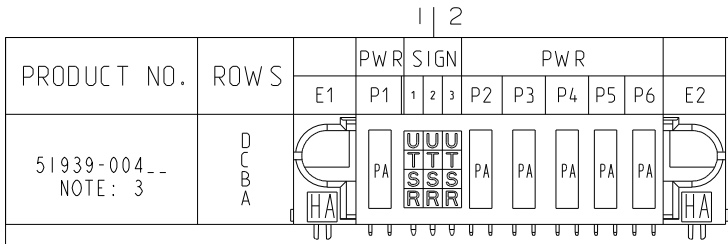

CODE	DIM "M" MATING LENGTH	CONTACT TYPE
R	[6.86]	SIGNAL
S	[6.86]	SIGNAL
T	[6.86]	SIGNAL
U	[6.86]	SIGNAL
PA	[N/A]	POWER
HA	[N/A]	HOLD-DOWN

mat'l code				SEE NOTE		tolerances unless otherwise specified		CUSTOMER	
ltr	ecn no.	dr	date	linear	angles	COPY		projection	
A	V12793	JWS	12/12/01	0.X ± 0.5	0° ± 2°	MM		title	
B	DG05-0240	GuoJM	07/26/05	0.XX ± 0.25		1:1		IP + 12S + 5P	
C	DG06-0008	JMG	01/07/06	0.XXX ± 0.10				RIGHT ANGLE SOLDER HEADER	
D	DG08-0272	JW	09/27/08					product family	
				engr	J. SHAFFER	12/12/01		PwrBlade	
				chr	M. MOSTOLLER	12/12/01		code	
				appd	M. MOSTOLLER	12/12/01		213	
sheet index	revision sheet	D 1	D 2	D 3	D 4			sheet 1 of 4	

product family		code	
PwrBlade		213	
size	dwg no	sheet	
A	51939-004	1 of 4	

A

A

B

B

Tous droits strictement reserves. Reproduction ou communication a des tiers interdite sous quelque forme que ce soit sans autorisation ecrite du proprietaire. Propriete de c FCI. Droits de reproduction FCI.

All rights strictly reserved. Reproduction or issue to third parties in any form whatever is not permitted without written authority from the proprietor. Property of FCI. Copyright FCI.



PRODUCT NUMBER

51939-004--
NOTE: 3

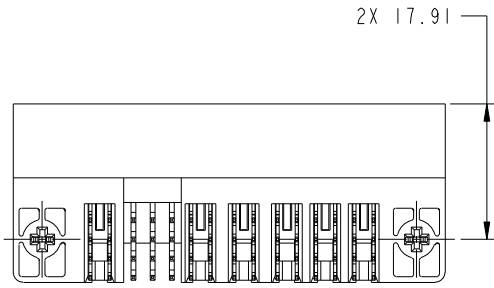

SECTION D-D

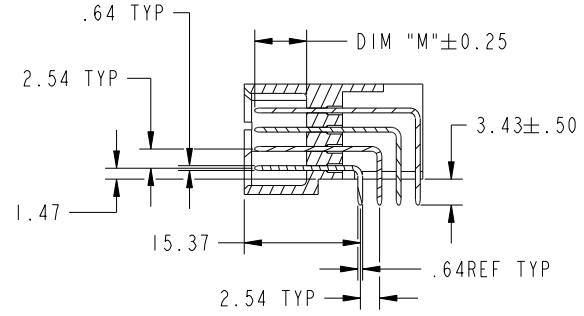

SECTION A-A

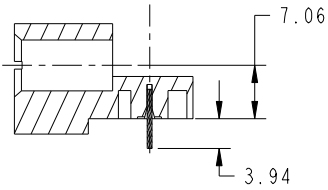

SECTION C-C

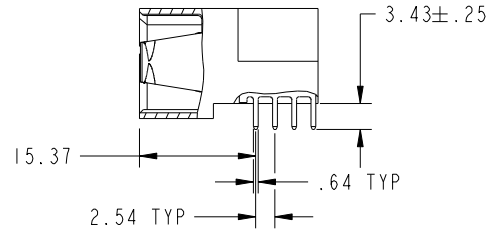

SECTION B-B

mat'l code		SEE NOTE		tolerances unless otherwise specified		CUSTOMER		 www.fciconnect.com			
lir	ecn no.	dr	date	linear	0.X ±0.5	projection		title			
D					0.XX ±0.25			IP + 12S + 5P		code	
					0.XXX ±0.10			RIGHT ANGLE SOLDER HEADER		213	
				angles	0° ±2°	 MM 1:1	product family		sheet		
				dr	J. SHAFFER 12/12/01		PwrBlade		2		
				engr	M. MOSTOLLER 12/12/01		size	dwg no	A 51939-004		
				chr	M. MOSTOLLER 12/12/01						
				appd	M. MOSTOLLER 12/12/01						
sheet index	revision sheet										

1 | 2

3 |

4

A

A

B

B

1 | 2

Pro/E

PDM: Rev:D

STATUS: Released

Printed: Oct 17, 2008

cage code 2856

Tous droits strictement reserves. Reproduction ou communication a des tiers interdite sous quelque forme que ce soit sans autorisation ecrite du proprietaire. Propriete de c.FCI. Droits de reproduction FCI.

All rights strictly reserved. Reproduction or issue to third parties in any form whatever is not permitted without written authority from the proprietor. Property of FCI. Copyright FCI.



PRODUCT NUMBER

51939-004--
NOTE: 3

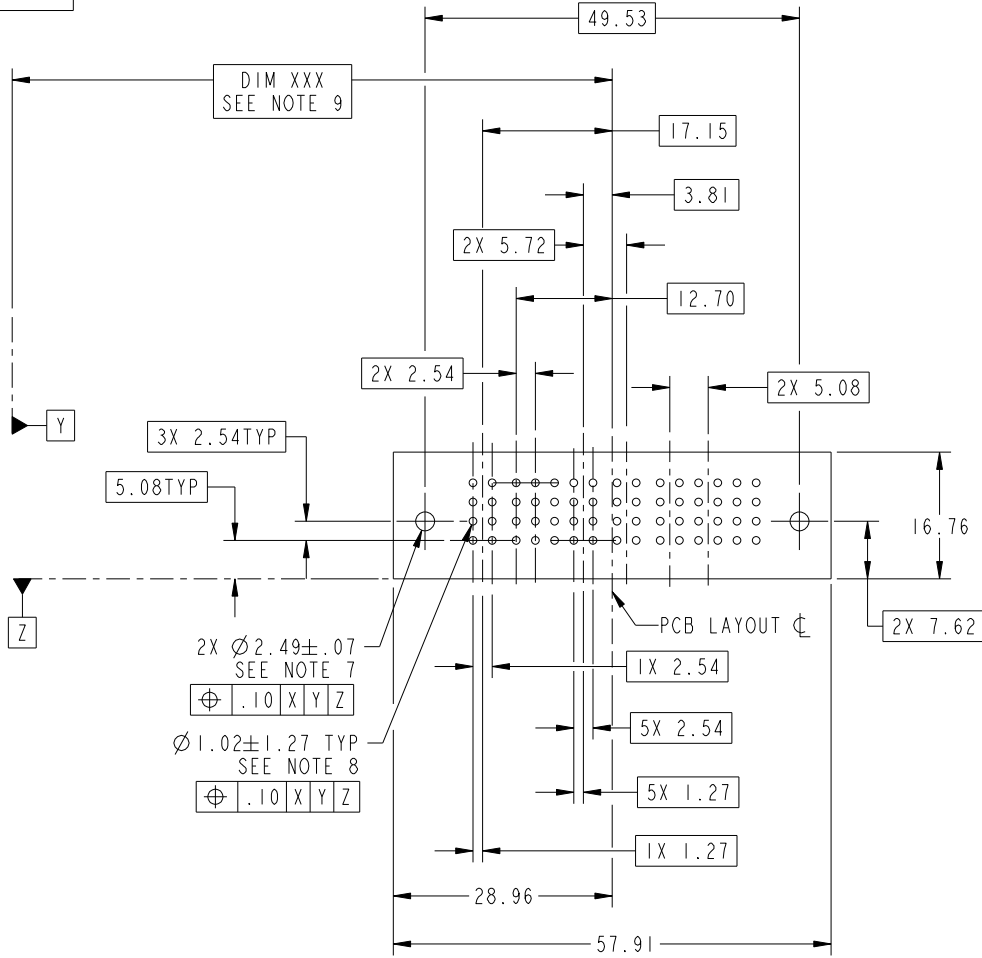

RECOMMENDED PCB LAYOUT

mat'l code		SEE NOTE		tolerances unless otherwise specified		CUSTOMER		 www.fciconnect.com		
lir	ecn no.	dr	date	linear	0.X ± 0.5		COPY		title IP + 12S + 5P RIGHT ANGLE SOLDER HEADER	
D					0.XX ± 0.25		projection			
					0.XXX ± 0.10					
				angles	0° ± 2°		 MM		product family PwrBlade	
				dr	J. SHAFFER	12/12/01	scale 1:1			code 213
				enrg	M. MOSTOLLER	12/12/01	size	dwg no		sheet
				chr	M. MOSTOLLER	12/12/01	A	51939-004		3
				appd	M. MOSTOLLER	12/12/01				
sheet index	revision sheet									

A

B

A

B

1 | 2

3

4

1 | 2

Pro/E

PDM: Rev:D

STATUS: Released

Printed: Oct 17, 2008

cage code 28506

4

Tous droits strictement reserves. Reproduction ou communication a des tiers interdite sous quelque forme que ce soit sans autorisation ecrite du proprietaire. Propriete de c.FCI. Droits de reproduction FCI.

All rights strictly reserved. Reproduction or issue to third parties in any form whatever is not permitted without written authority from the proprietor. Property of FCI. Copyright FCI.



1 | 2

3

4

PRODUCT NUMBER
51939-004--
NOTE: 3

NOTES:

1. DIMENSIONS AND TOLERANCES ARE IN ACCORDANCE WITH ASME Y14.5M, 1994 UNLESS OTHERWISE SPECIFIED.

CONNECTORS NOTES:

2. HOUSING MATERIAL: UL 94 V-0 GLASS FILLED HIGH TEMP THERMO PLASTIC
POWER CONTACT MATERIAL: COPPER ALLOY
SIGNAL PIN MATERIAL: COPPER ALLOY

3. PLATING
SEE ITEM 1 & 2 IN PRINT 10064183 FOR PLATING SPEC OF 51939-004; 51939-004LF PRESPECTIVELY

4. "MANUFACTURER" NAME, P/N, AND DATE CODE TO APPEAR ON THIS SURFACE.

5. PRODUCT SPECIFICATION GS-12-149.

PCB - NOTES:

6. ALL HOLE DIAMETERS ARE FINISHED HOLE SIZE.

7. HOLD DOWN THROUGH HOLES ARE UNPLATED.

8. $\varnothing 1.151 \pm 0.025$ DRILLED HOLES PLATED WITH 0.008 MIN SnPb OR Sn OVER 0.03 TO 0.08 Cu PLATING TO ACHIEVE $\varnothing 1.02 \pm .07$ HOLE.

9. "DIM XXX" TO BE DETERMINED BY THE CUSTOMER.

10. SYMBOL WILL BE NEXT TO ANY DIMENSION, VIEW, OR NOTE WHICH HAS BEEN MODIFIED WITH THE CURRENT DRAWING REVISION.

mat'l code		SEE NOTE		tolerances unless otherwise specified		CUSTOMER				www.fciconnect.com	
lir	ecn no.	dr	date	linear	0.X ±0.5		COPY		title IP + 12S + 5P RIGHT ANGLE SOLDER HEADER		
D					0.XX ±0.25		projection				
					0.XXX ±0.10						
				angles	0° ±2°				product family PwrBlade code 213		
		dr	J. SHAFFER 12/12/01	enrg	M. MOSTOLLER 12/12/01	scale		size A		dwg no 51939-004 sheet 4	
		chr	M. MOSTOLLER 12/12/01	appd	M. MOSTOLLER 12/12/01	1:1					
sheet index	revision sheet										

A

A

B

B

1 | 2

Pro/E

PDM: Rev:D

STATUS: Released

Printed: Oct 17, 2008